

# TOTALTRUSS

COMPLETE STEEL FRAMING TRUSS SOLUTIONS



[www.iSPANsystems.com](http://www.iSPANsystems.com)





# TOTALTRUSS

## LIGHT STEEL FRAME TRUSSES

In order to provide builders and developers a complete structure, iSPAN Systems LP has developed TotalTruss.

iSPAN's 3D TotalTruss design allows any complex roof to be modelled and fabricated to allow for concise and easy installation on-site. There is no limit to what TotalTruss can do and iSPAN has completed many projects that include co-ordination of mechanical, stepped and scissor trusses, and large hip trusses where they custom fabricate structural girders.

Please contact iSPAN Systems for your next residential, commercial or industrial project.

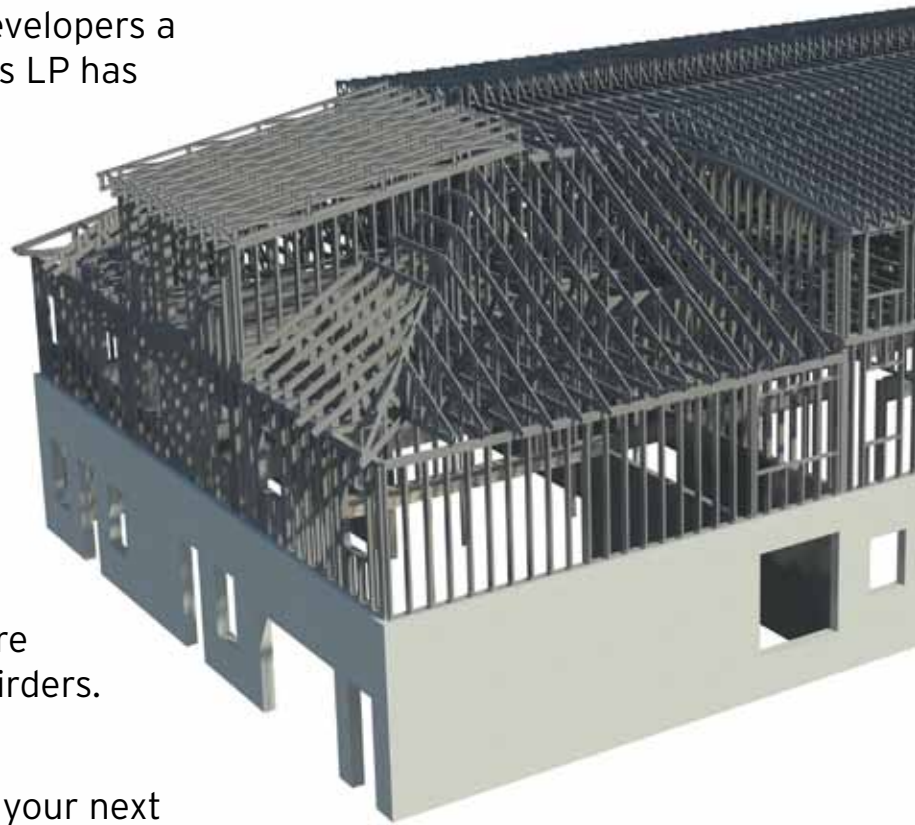

**iSPAN**<sup>®</sup>  
**SYSTEMS**

**iSPAN SYSTEMS LP**  
PO BOX #442, 70 Brentwood Drive  
Princeton, Ontario, Canada N0J 1V0  
**T** 519-458-4222 **F** 519-458-4460  
[www.iSPANsystems.com](http://www.iSPANsystems.com)