

GENERAL DETAILS

100 TYPICAL FLOOR CONSTRUCTION

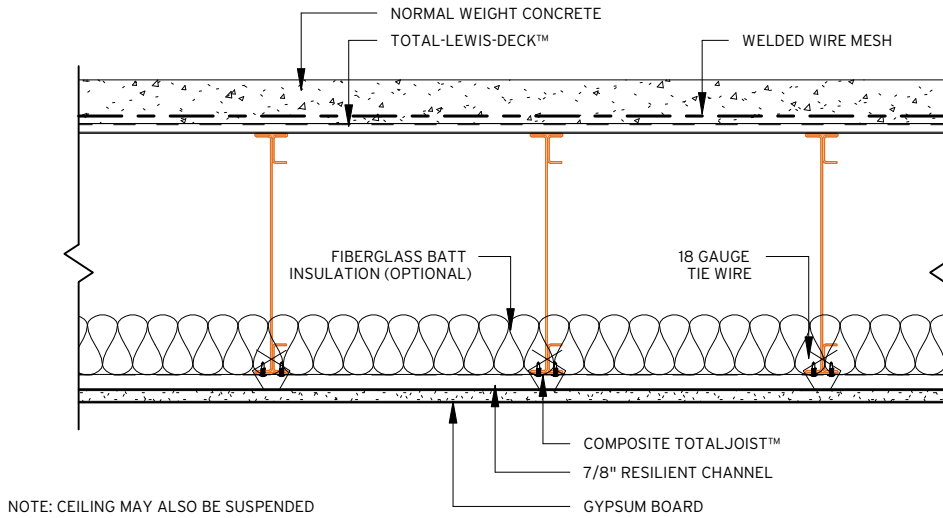

101 CROSS BRIDGING INSTALLATION

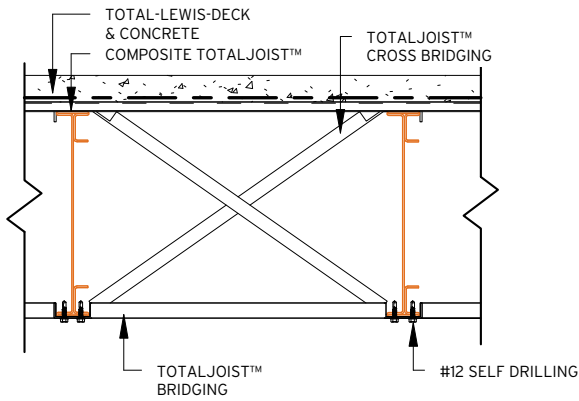

102 END CONNECTION

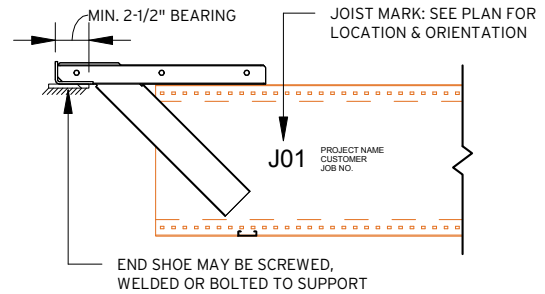

103 SINGLE PLY CONNECTION TO MULTI-PLY JOIST

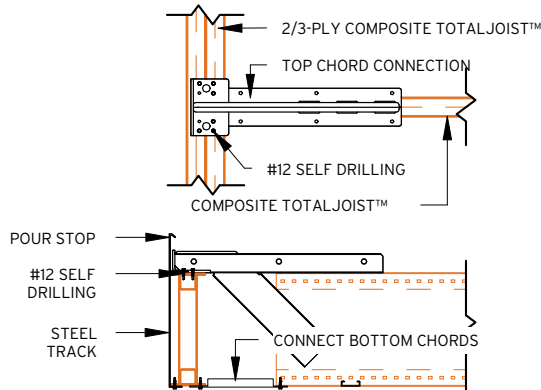

104 MULTI-PLY CONNECTION TO MULTI-PLY JOIST

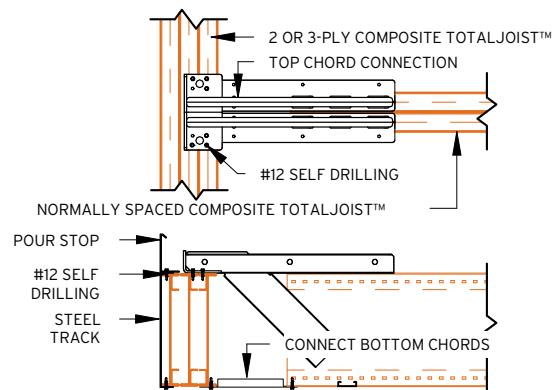

GENERAL DETAILS

105 BLOCKING AND BRIDGING LAYOUT

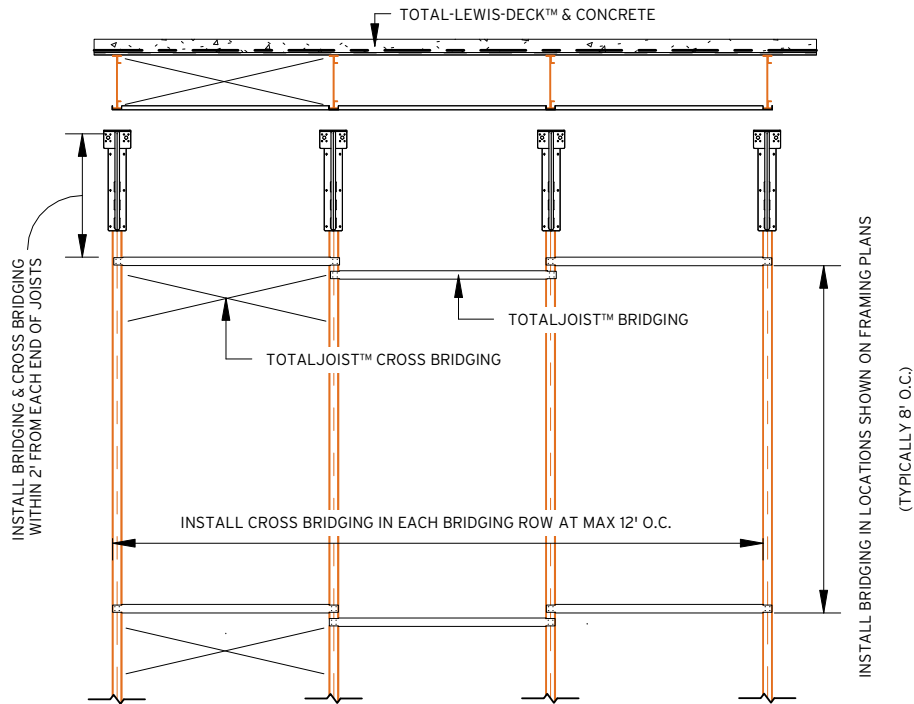

106 OPENING FRAMING

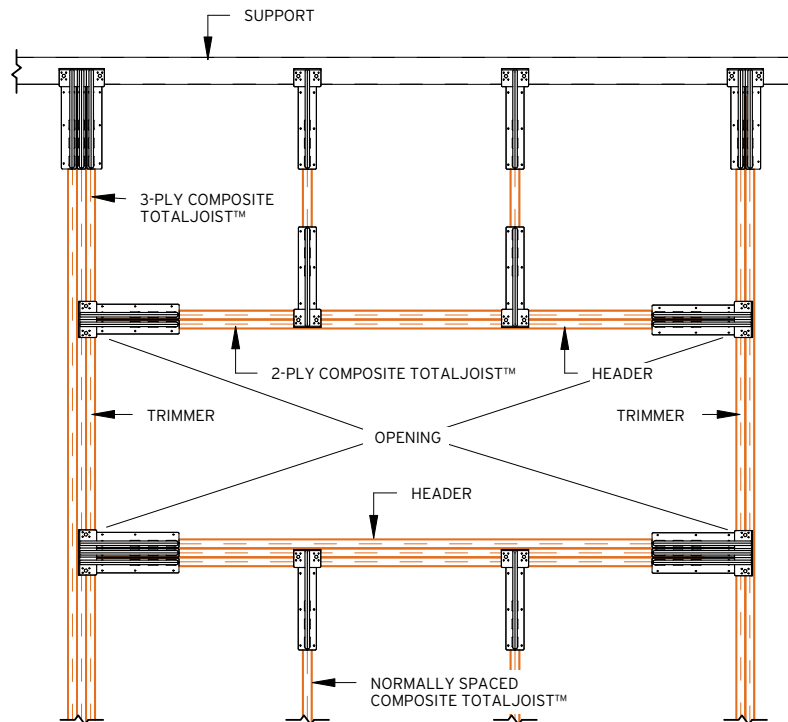

GENERAL DETAILS

107 DECK FASTENER PATTERNS

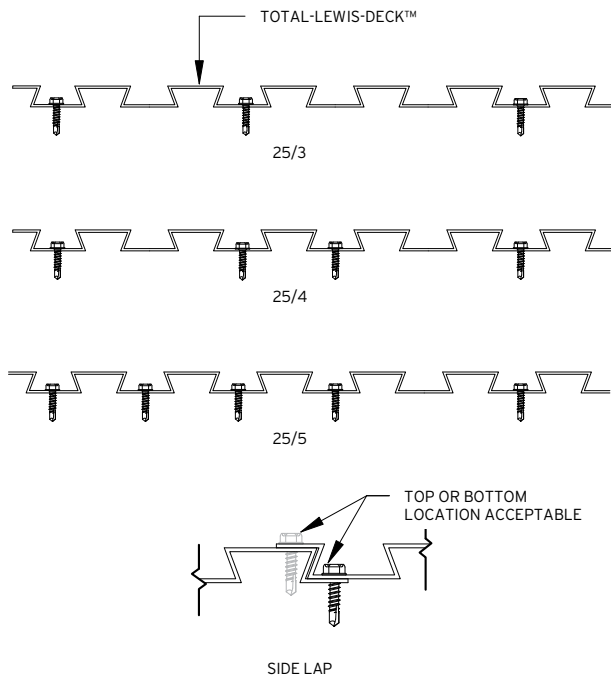

108 HOLE SIZE

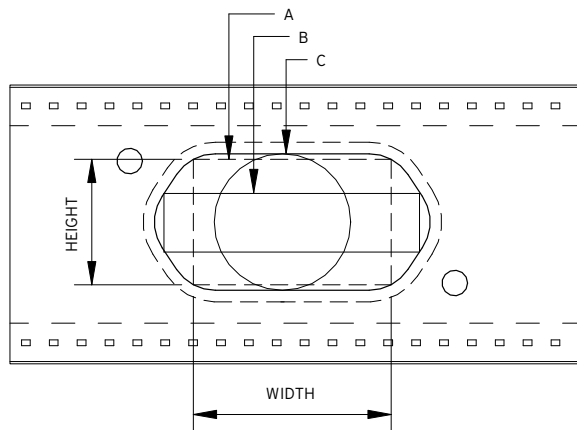

JOIST DEPTH	A		B		C
	HEIGHT	WIDTH	HEIGHT	WIDTH	
10"	4"	3-1/2"	6"	2-1/4"	3-1/2"
12"	6-5/8"	5-7/8"	9-7/8"	4"	5-7/8"
14"	8-1/4"	8"	12-3/4"	5-5/8"	8"
16"	9"	10"	14-5/8"	6-7/8"	10"

109 POUR STOP

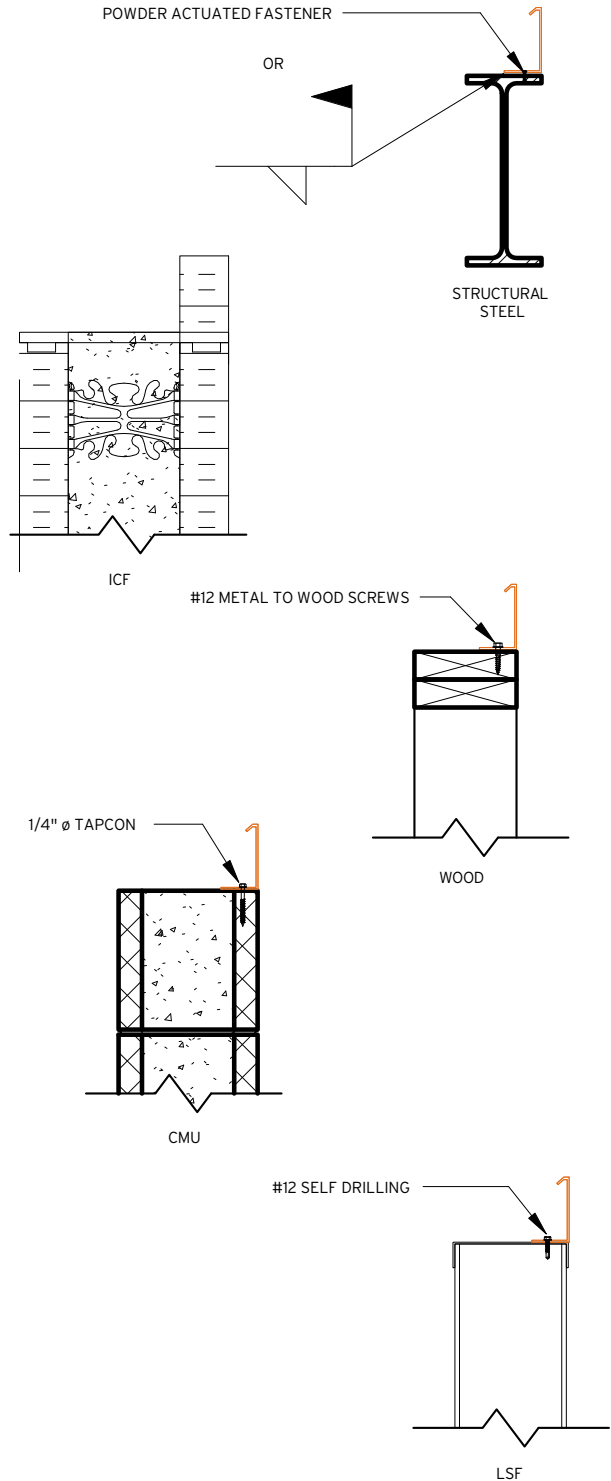

DECK INSTALLATION

STEP 1 INSTALL STARTER DECK

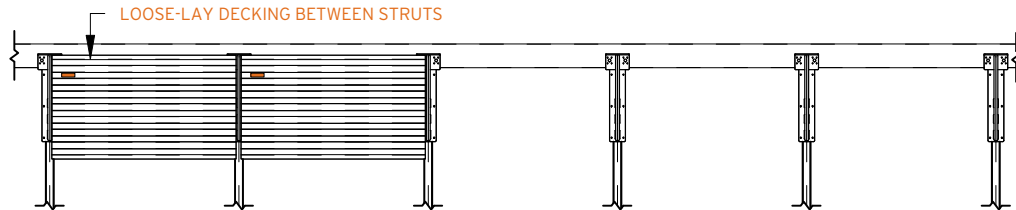

STEP 2 INSTALL STICKER SIDE DOWN PIECES

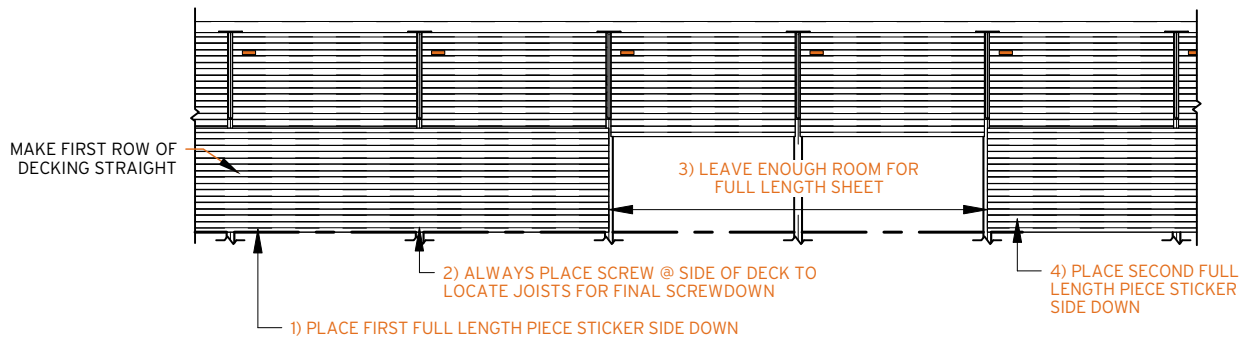

STEP 3 INSTALL STICKER SIDE DOWN PIECES

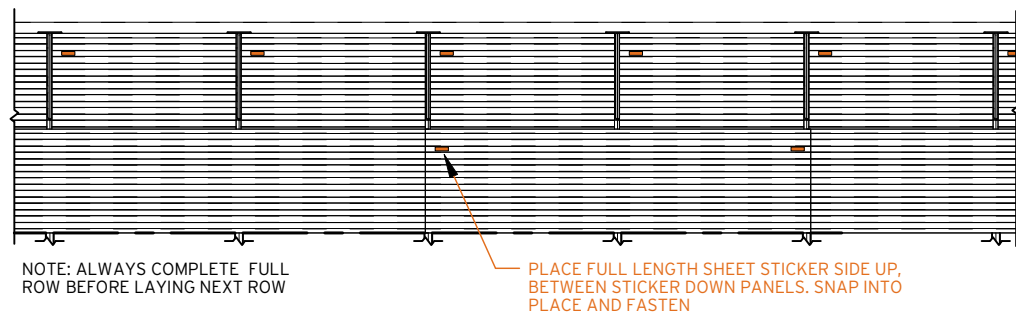

STEP 4 PLACE REMAINDER OF FULL LENGTH PANELS

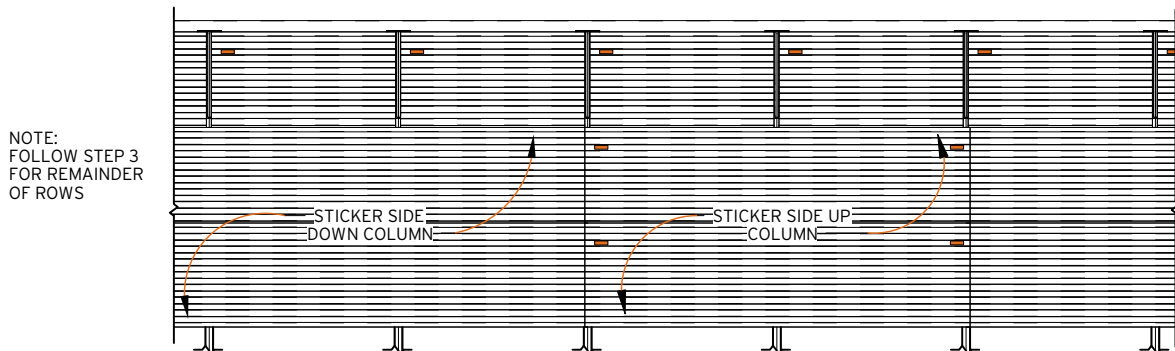

DECK INSTALLATION

STEP 5 OPTION 1: INSTALL END DECK OPTION

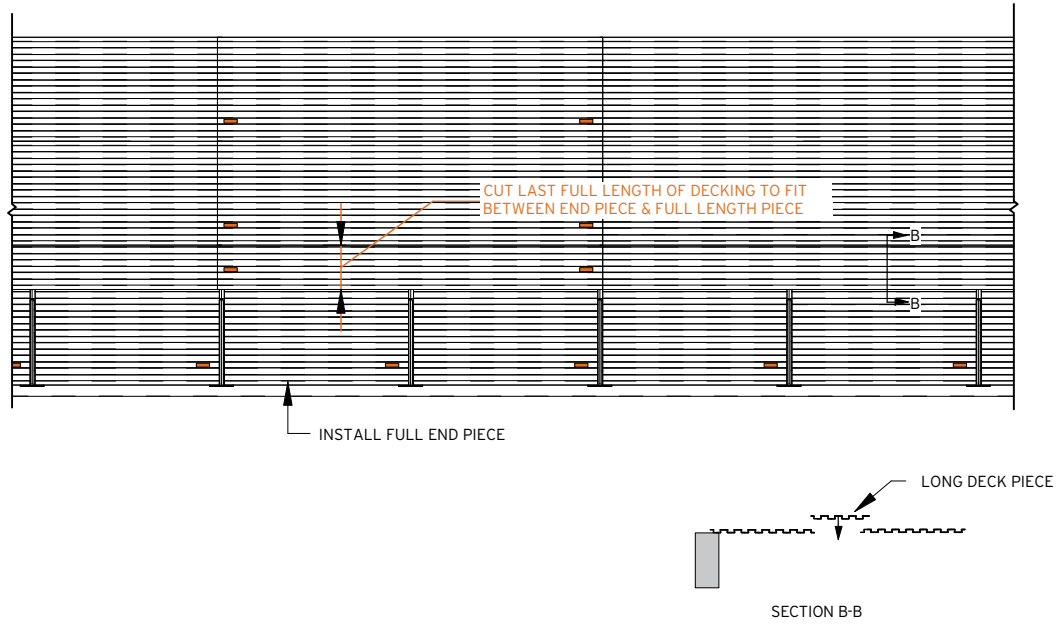

STEP 5 OPTION 2: INSTALL END DECK OPTION

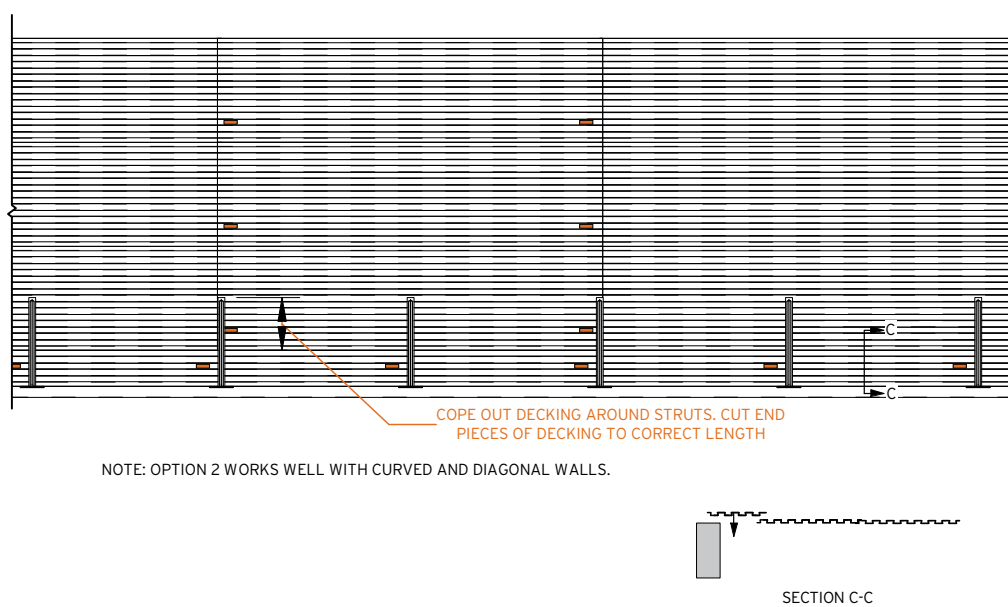

CONNECTION DETAILS

<p>200 CONNECTION TO STRUCTURAL STEEL BEAM</p> <p>NOTE: ALTERNATIVELY SHOE MAY BE FASTENED WITH SELF DRILLING SCREWS</p>	<p>201 PARALLEL TO STRUCTURAL STEEL BEAM</p>
<p>202 TIE JOIST</p> <p>NOTE: ALTERNATIVELY SHOE MAY BE FASTENED WITH SELF DRILLING SCREWS</p>	<p>203 CONNECTION TO STEEL STUD WALL</p>
<p>204 CONNECTION PARALLEL TO STEEL STUD WALL</p>	<p>205 CONNECTION TO MASONRY WALL</p>

CONNECTION DETAILS

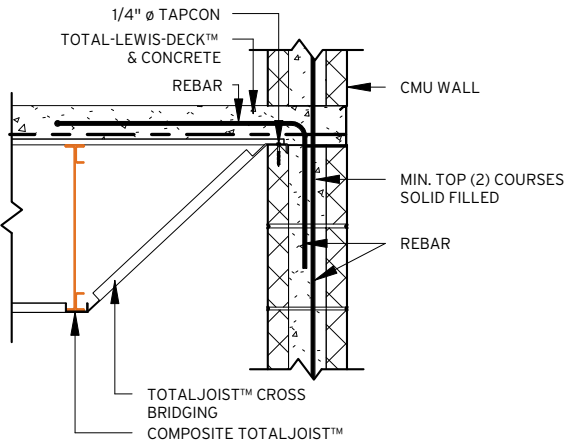
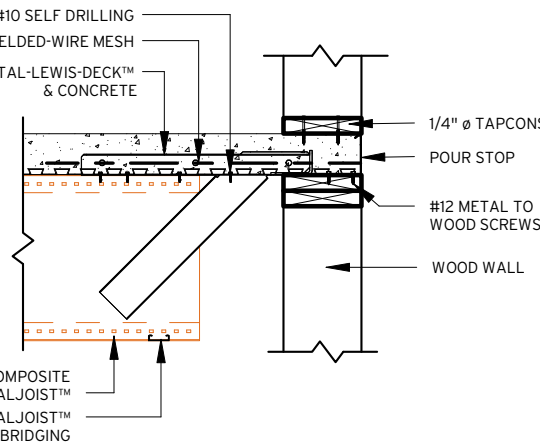
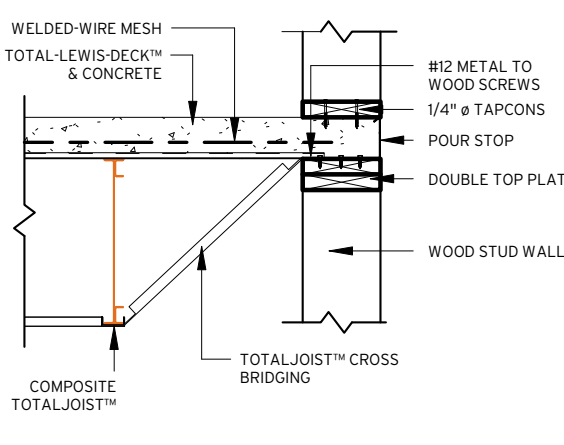
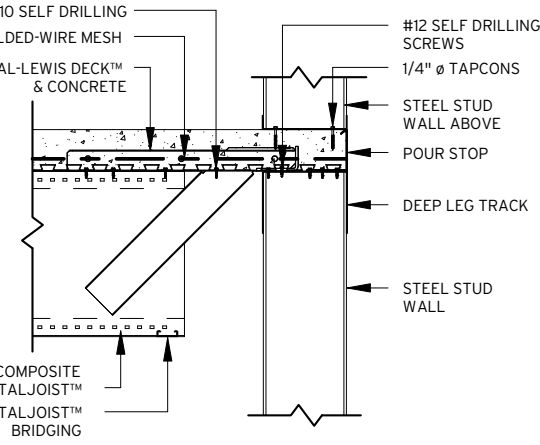
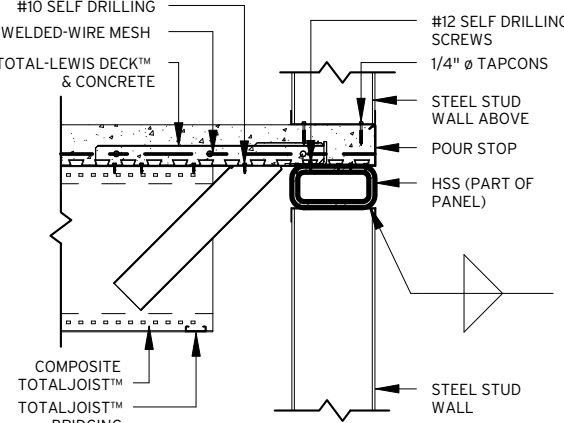
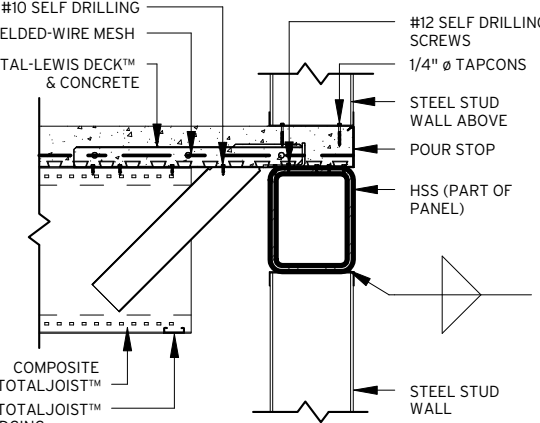
<p>206 PARALLEL TO MASONRY WALL</p> 	<p>207 CONNECTION TO WOOD STUD WALL</p> 
<p>208 CONNECTION PARALLEL TO WOOD STUD WALL</p> 	<p>209 CONNECTION TO STEEL STUD WALL W/ DEEP LEG TRACK</p> 
<p>210 CONNECTION TO STEEL STUD WALL - SHALLOW HSS</p> 	<p>211 CONNECTION TO STEEL STUD WALL - DEEP HSS</p> 

CONNECTION DETAILS

